

The other part of the
whole tract belong-
ing to George Etzler

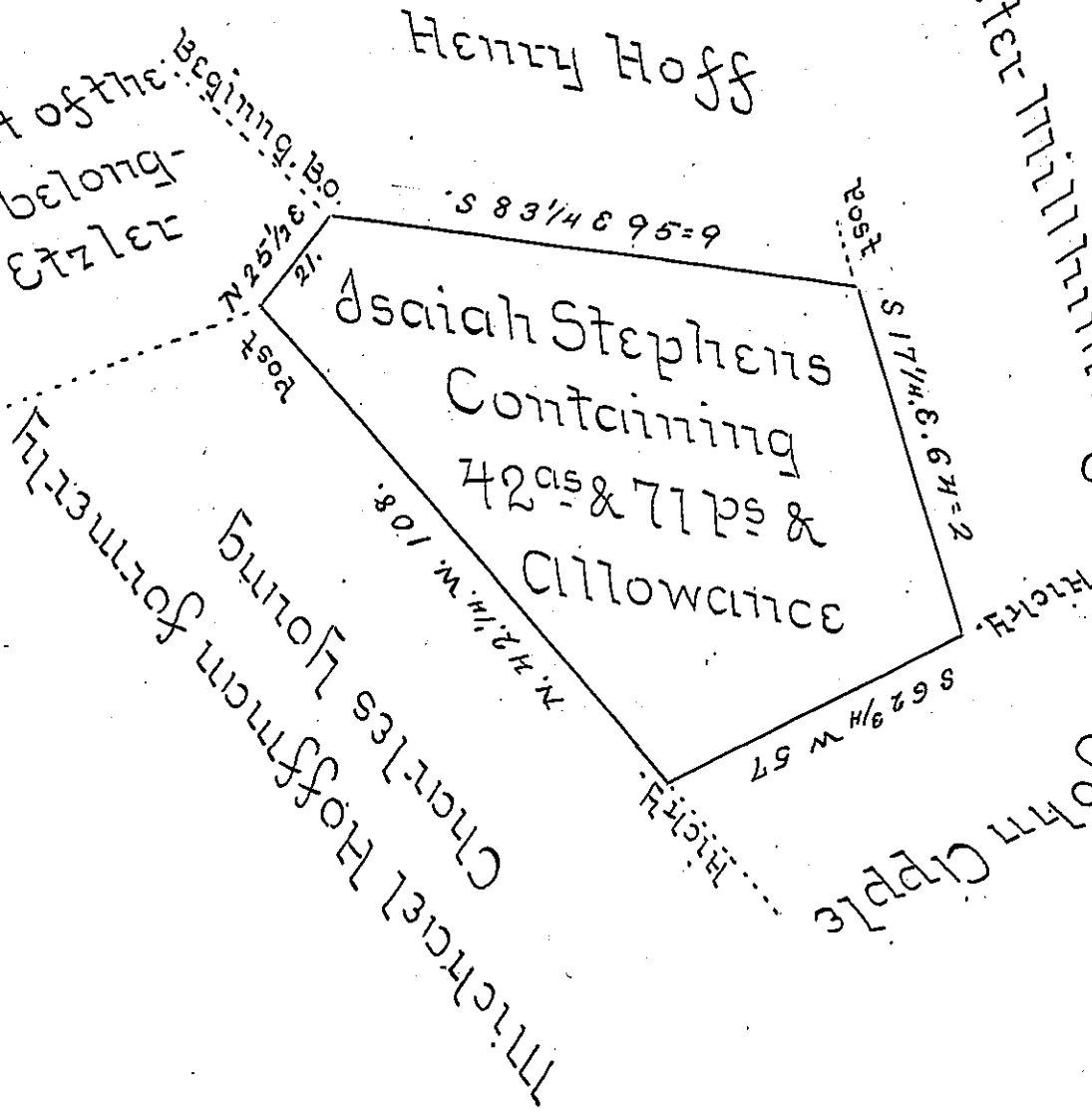

Situated in Manheim Township in the County of York
Containing as above set forth 42^{acs} & 71 Perches and
allowance being part of a larger tract of 90^{acs} &
allowance which was originally surveyed by Arch-
ibald McLean late U.S. in the year 1767 for Isaiah
Stephens. In pursuance of an Order of Survey No
1559 dated October 17th 1766. Resurveyed and divid-
ed off from the said larger tract of land the 31st
day of July Anno-Domini 1807 for Francis Hines
the present owner. — per

Jacob Spangler U.S.

To Andrew Porter Esq }
Surveyor General }
Lancaster Pa — }

IN TESTIMONY that the above is a copy of the original remaining on file in
the Department of Internal Affairs of Pennsylvania, made
conformably to an Act of Assembly approved the 16th day of
February, 1833, I have hereunto set my Hand and caused
the Seal of said Department to be affixed at Harrisburg,
this twenty third day of May 1905.

Samuel P. Ross
Secretary of Internal Affairs.